

assembly instructions FM600

STEP 01

Place the bed on a sturdy underground.



STEP 02

Place the cushions into the bed. Place the cushion in a way that the holes correspond with the holes of the bed.



STEP 03

Take screw set : **SB02 (Butt Hinge Security Pen)**

Install the **base profile** on the bed. Make sure both hinge parts fits on the rear side of the cabin. If it does not fit, remove one or two plastic rings on the hing bracket that is mounted on the bed.

Knock in completely both hinge security pens.



front side



rear side

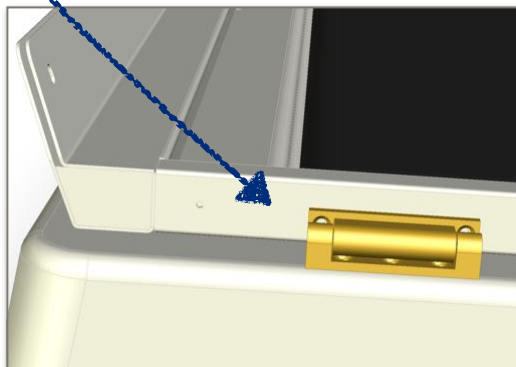

Knock in completely both hinge security pens.

STEP 04

Place the **transparent dome sheet** into the base profile in a way that it follows the curve of the dome. Make sure that the rear side is equal to the rear side of the base profile. Normally the holes should fit the holes in the base profile (maybe only in the Y-direction).



When done, one person should hold the dome from the frontside in place until the rear and front panel is being placed (in a provisionally manner).

Another person should remove the security foil on both sides of the transparent dome sheet.

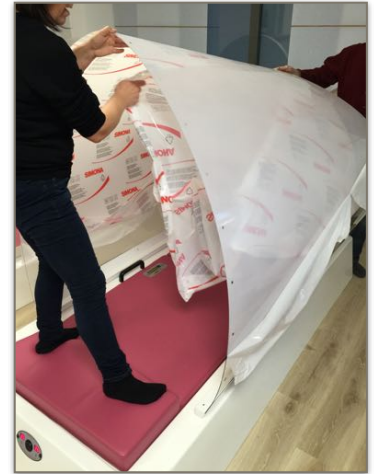

STEP 05

Another person must place the **rear panel**. Keep it provisionally in place by putting a small screwdriver through the top hole.

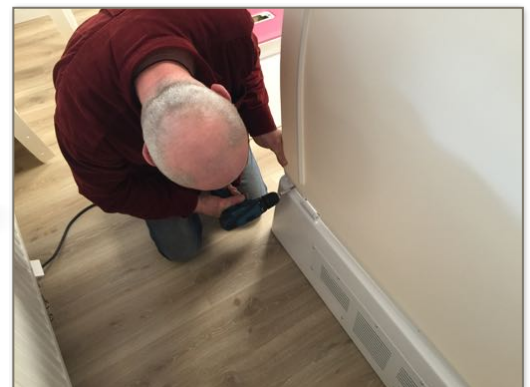
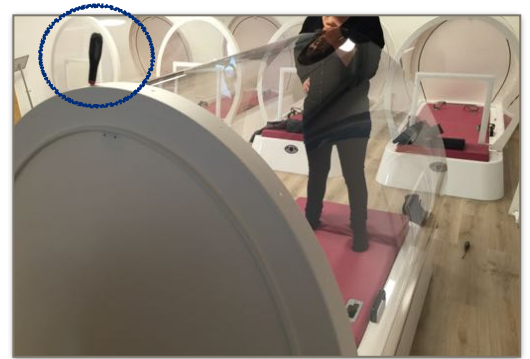
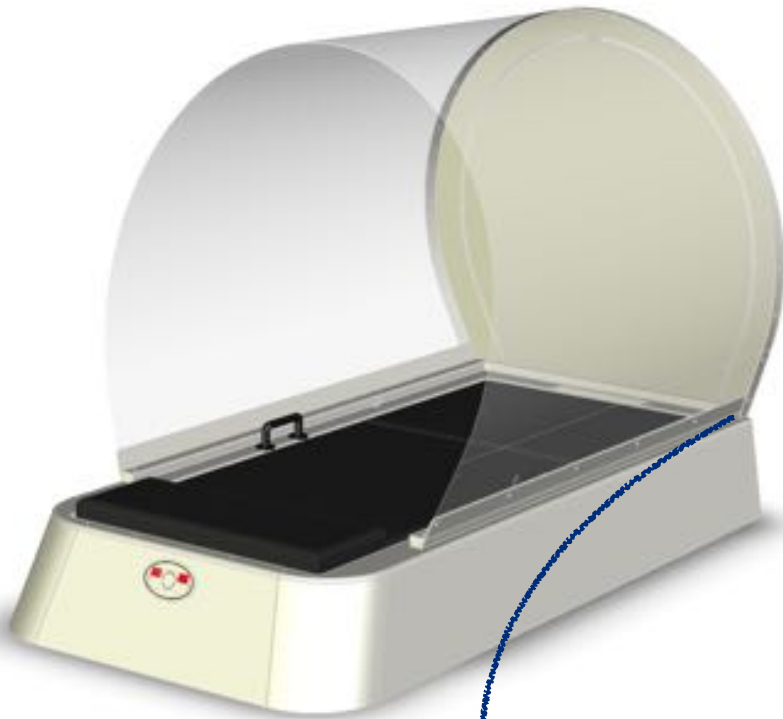

Make sure that the 6 fixing holes on the bottom of the rear panel approximately correspond with the 6 screw holes in the base profile.

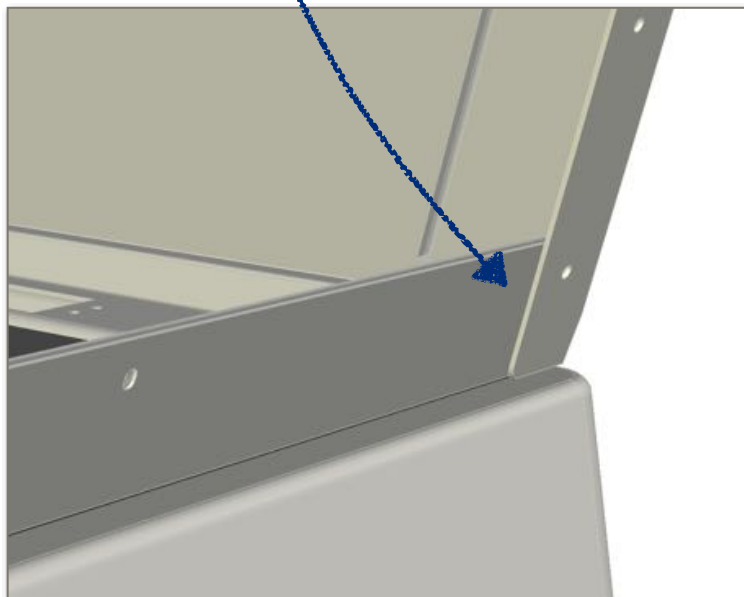

Make sure that both sides of the rear panel are at the outside of the base profile.

STEP 06

Now place **the front panel**. Keep it provisionally in place by putting a small screwdriver through the top hole. The other person should, of course, step aside.

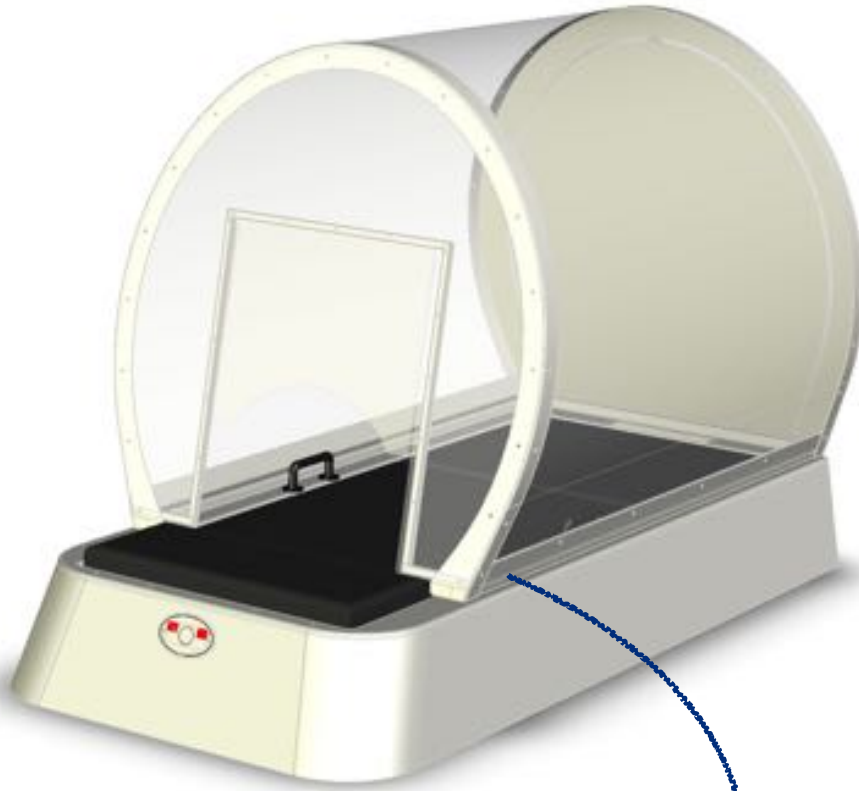

Make sure that the 2 fixing holes on the bottom of the front panel approximately correspond with the 2 screw holes in the base profile.

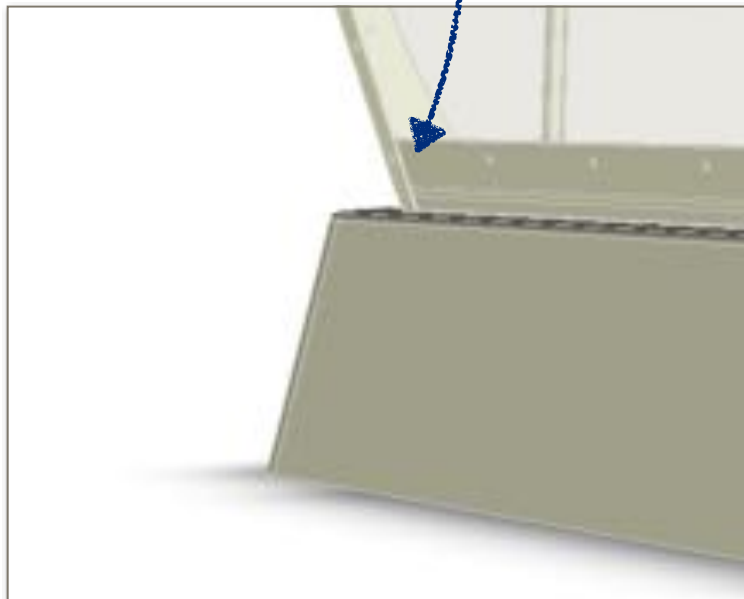

Make sure that both sides of the rear panel are at the outside of the base profile.

STEP07

Take screw set : **SB05 (Steel Screw M6x12)**

These screws are for fixing the bottom of the rear panel tot the base profile. Make sure holes correspond and screw them first a few turns by hand. If they all fit, firmly screw them (torque 7 on a accu screwdriver).

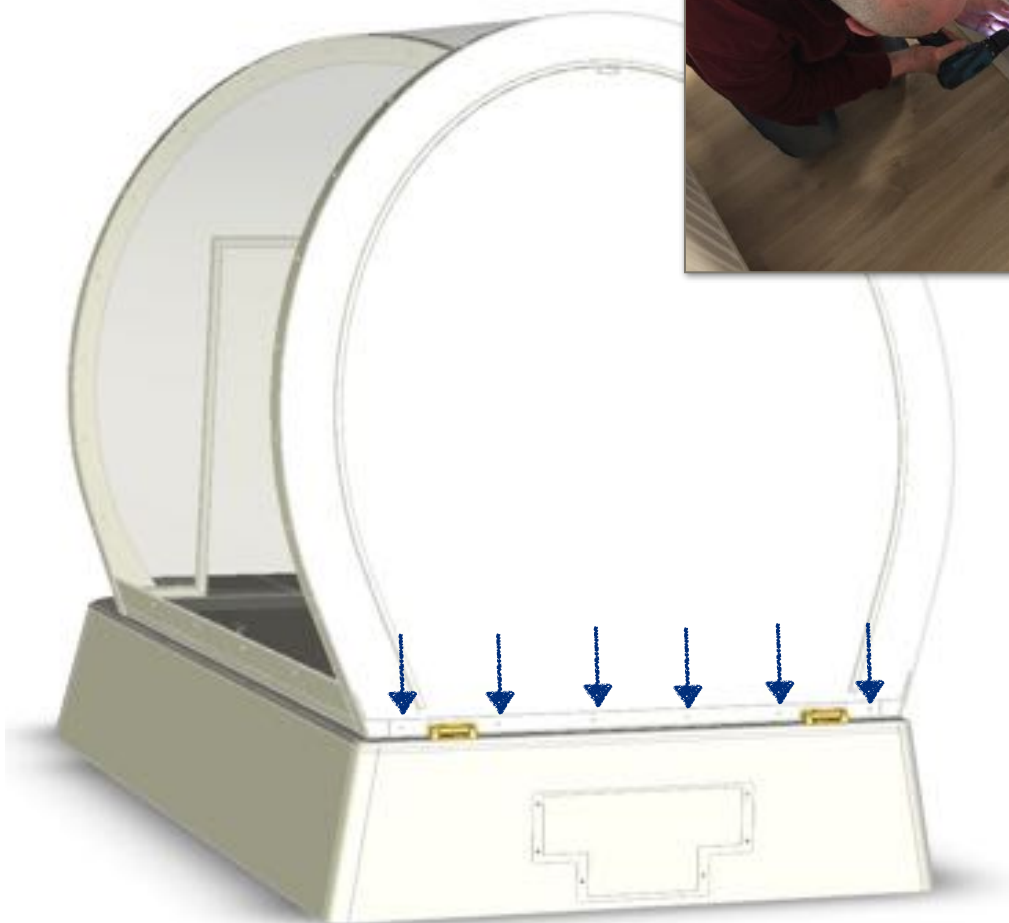

STEP 08

Take screw set : **SB03 (Hexagon Bolt M6x16)**

These screws are being used to fix the front panel with the base profile. Make sure holes correspond and screw first a few turns by hand while using a nylon cap washer flat* from screw set **SB07**. If they both fit, firmly screw them (torque 7 on a accu screwdriver).

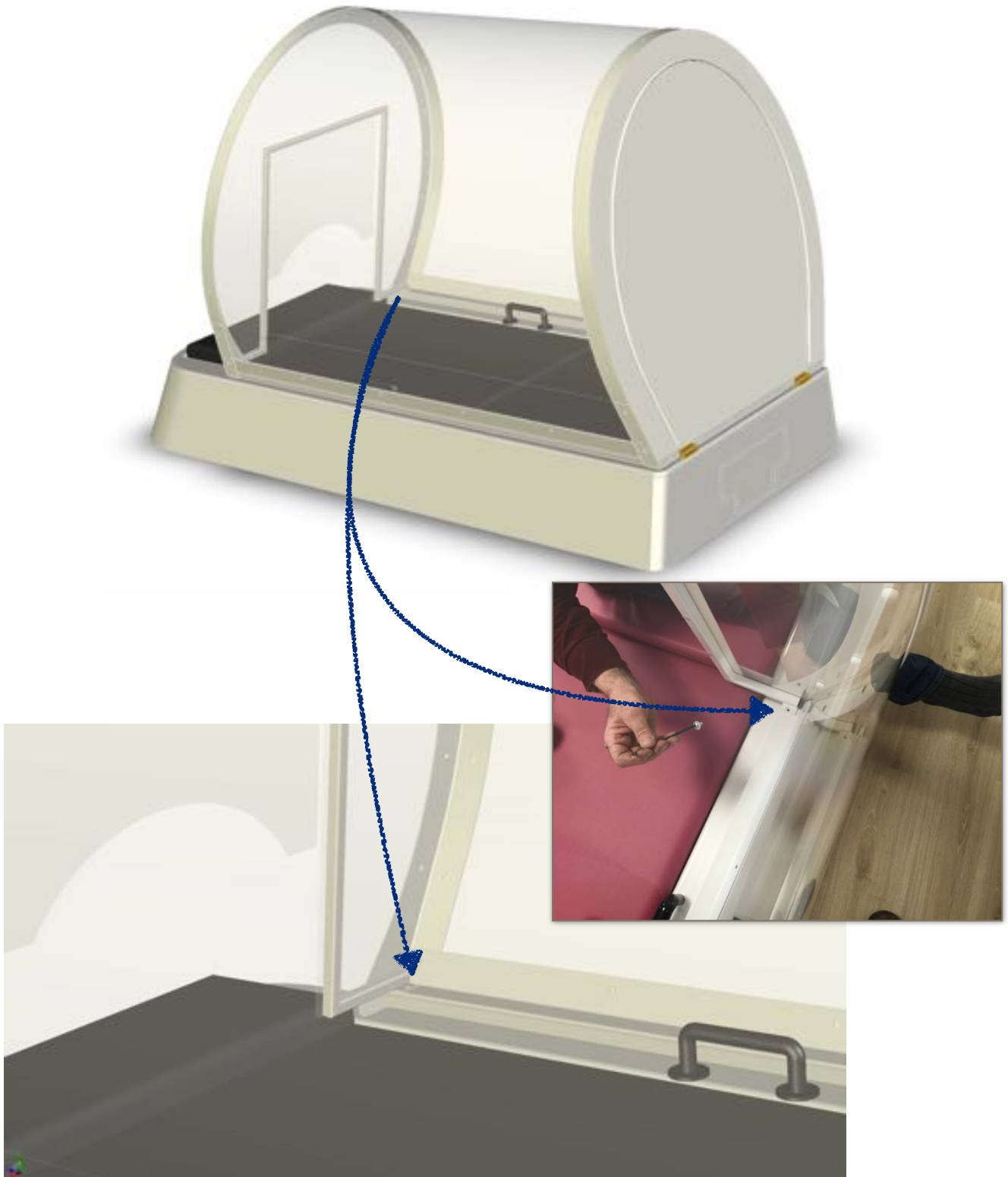

SCREWING THE DOME

Take screw set : **SB06 (Nylon Bolt M6x10)**

This screw set is being used for almost all holes on the side of the rear and front panel. **Always start screwing from the top.** Use a screwdriver for positioning the holes and start screwing from the top to bottom. Always use a nylon cap washer flat* from screw set **SB07** and a nut from screw set **SB08**. Fasten the nuts provisionally by hand.

Take screw set : **SB04 (Nylon Bolt M6x16)**

This screw set is being used for the 4 bottom holes on the side of the rear and front panel. Use a nylon cap washer flat* from screw set **SB07** and a nut from screw set **SB08**. Fasten the nuts provisionally by hand. (These screws are to long, but chosen for easy fixation in the first place).

Take screw set : **SB01 (Nylon Bolt M6x12)**

This screw set is being used for all holes between rear and front panel. Use a screwdriver for positioning the holes and start screwing from the top to bottom. Use a nylon cap washer flat* from screw set **SB07** and a nut from screw set **SB08**. Fasten the nuts provisionally by hand.

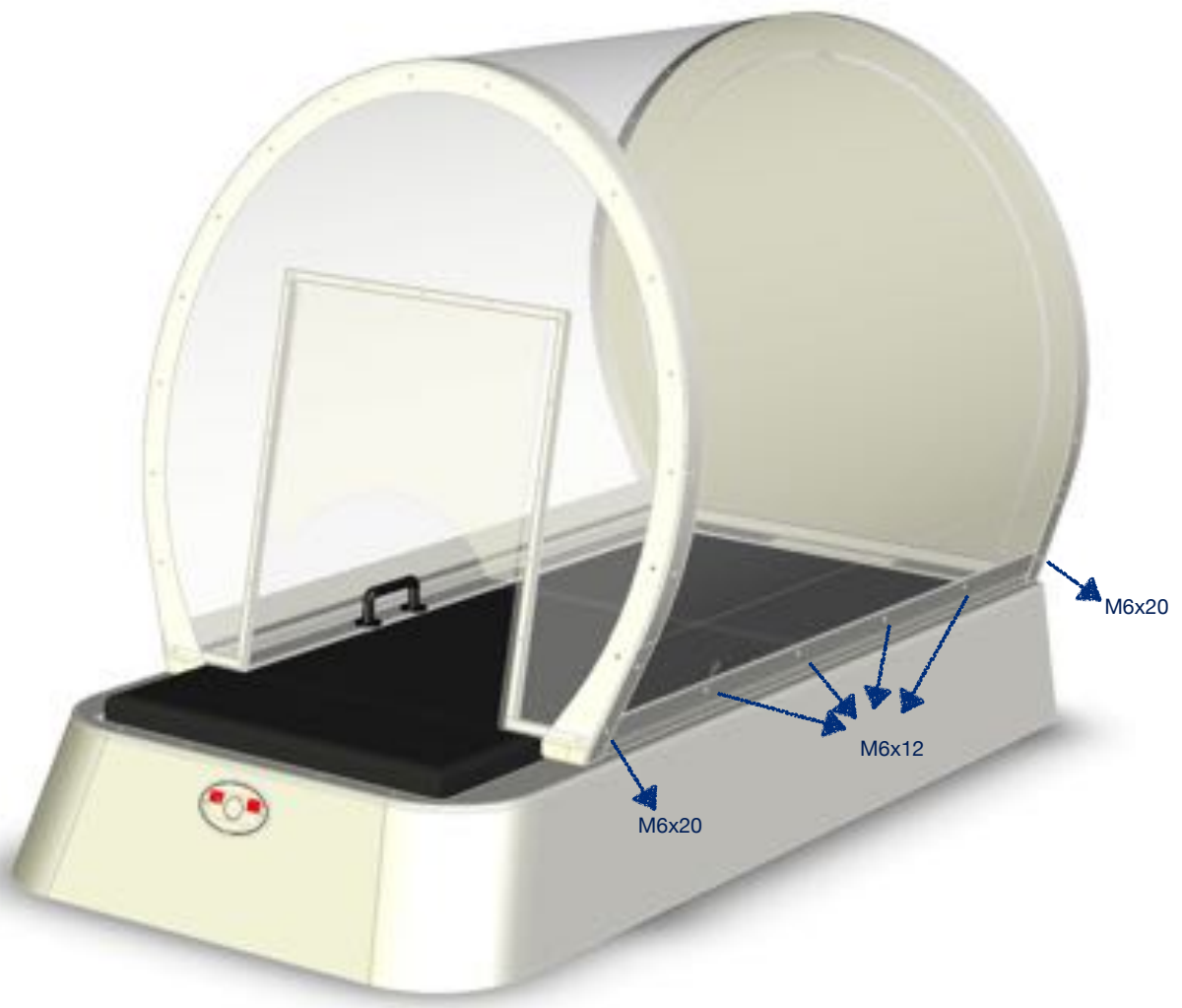

Finishing the dome.

Fasten all nuts firmly by using the right pip wrench or an accu screwdriver. Do not screw them too firmly (because they are from plastic). When using an accu screwdriver, make sure slow speed is selected and torque is not set over 4.

Shorten the 4 bottom screws for screw set SB04 (M6x20) with a small clipping plier.

DIAGONAL CUTTING PLIERS

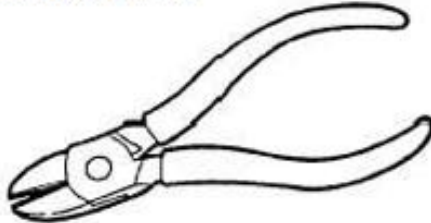

Take screw set : **SB09 (Nylon Cover Cap)**

These nylon cover caps are for making all screws invisible and to avoid sharp edges which one can hurt. Simply push them over the nuts until it clicks.

***How to use Snap-Caps**

The fixing is secured through the washer into the workpiece. The cap is then "snapped" over the washer, mating by means of an interlocking peripheral groove and flange. This provides an airtight and seal that excludes atmosphere and protects the fastener head from rust and corrosion.

Please use washer and caps as shown on the example below :

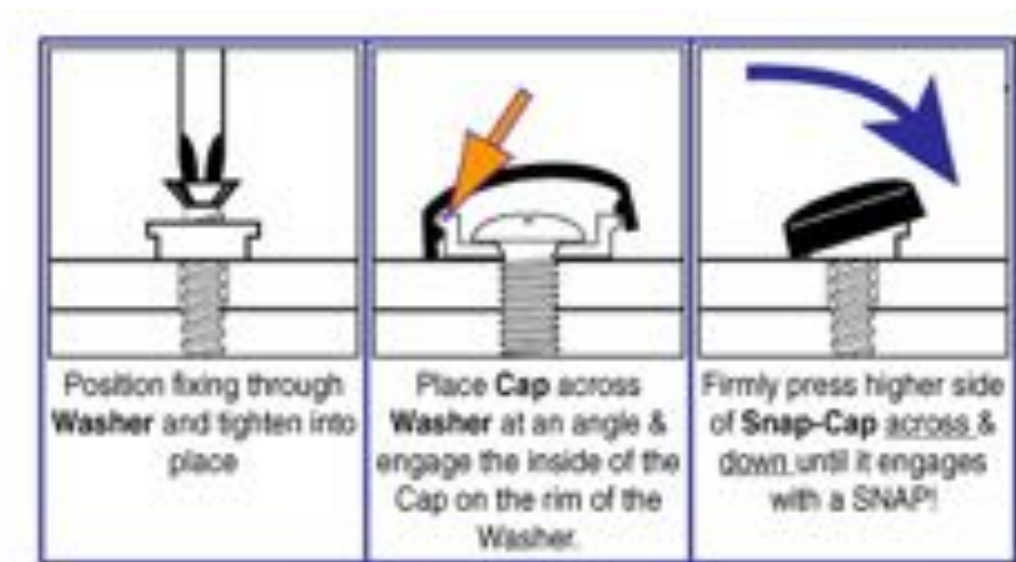

Take package : **SB10 (Temperature Sensor)**

This is the temperature sensor which measures the temperature inside the cabine. Put the sensor in the temperature enclosure. Make sure it is correctly polarized.

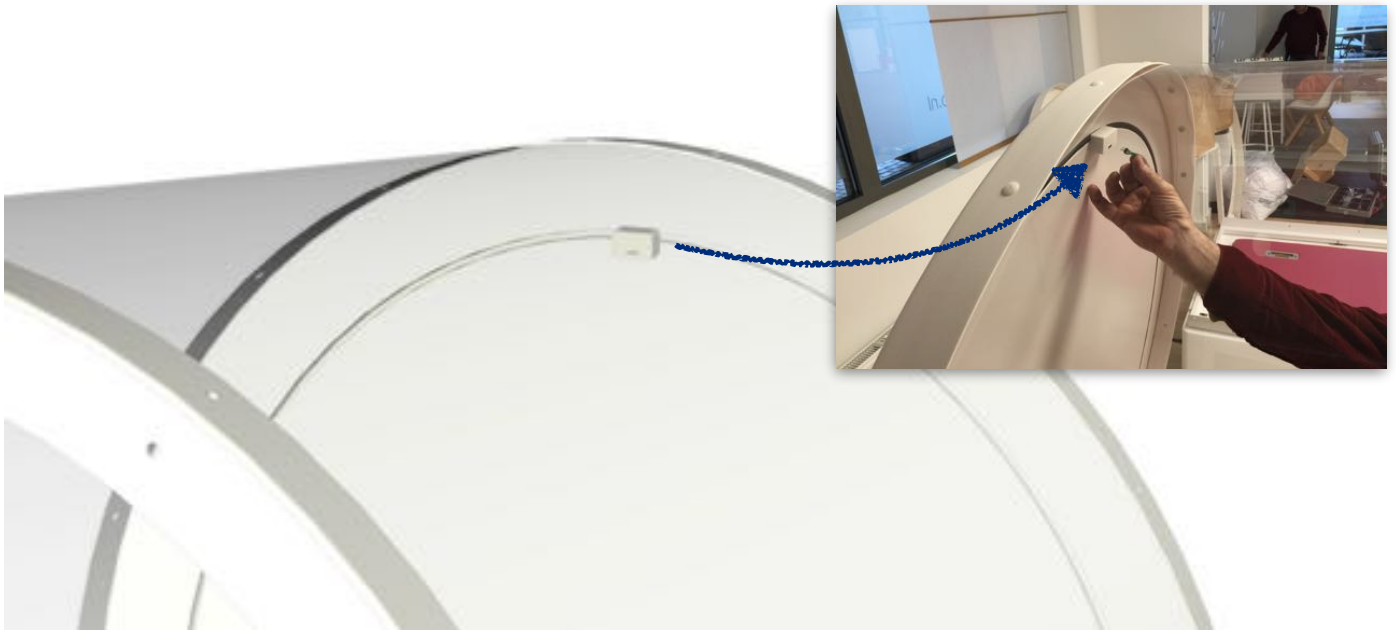

NOTE : Make sure power plug is disconnected when placing the temperature sensor.

Now click in the telephone connector inside the cabine (on the left rear side). This connects the sensor to the control panel.



Finish the installation by sliding in the in the weights (polarized) and tighten the screws by slightly pressing and $\frac{1}{4}$ turn clockwise them. To unlock : slightly pressing and $\frac{1}{4}$ turn counter clockwise the screws.

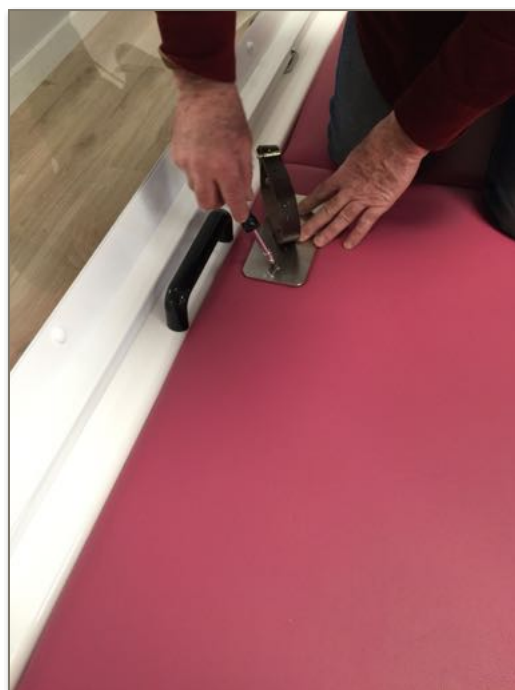
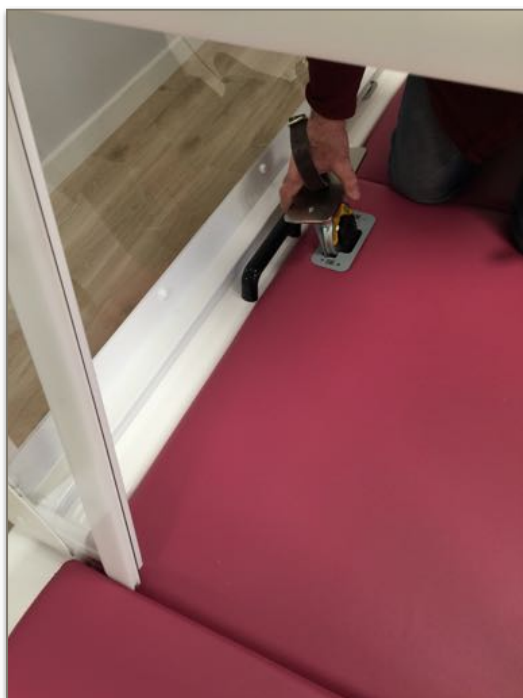

Put in the power cable and the cabin is ready for use.